

BUILDING/FACILITY KEY

DESCRIPTION	DESCRIPTION
① FBO / MAINTENANCE HANGAR (E)	⑫ TIEDOWN APRON
② FBO BUILDING (F)	⑬ WAAAM OVERFLOW AIRCRAFT PARKING (F)
③ MAINTENANCE HANGAR (F)	⑭ TRANSIENT HELICOPTER PARKING
④ HANGARS (E)	⑮ AUTO PARKING (F)
⑤ BOX HANGARS (F)	⑯ WIND TEE (E)
⑥ MULTI-UNIT HANGARS (F)	⑰ SUPPLEMENTAL WIND TEE (E)
⑦ COMMERCIAL HANGAR (F)	⑱ AWOS (E)
⑧ REGULATOR BUILDING	⑲ PROPERTY TO BE ACQUIRED
⑨ AGRICULTURAL OPS AREAS	⑳ GLIDER STORAGE / PARKING AREA (E/F)
⑩ FUEL LOCATION (E)	㉑ OVERFLOW PARKING AREA (F)
⑪ FUEL LOCATION (F)	㉒ TEMPORARY FUEL LOCATION

NON STANDARD CONDITIONS

NO.	ITEM	DESCRIPTION	DISPOSITION
①	ROFA	SOUTHEAST SIDE RESIDENCES	FUTURE PROPERTY ACQUISITION
②	TAXILANE OFA APRON	TAXILANE CLEARANCES TO PARKED AIRCRAFT (ADG I & ADG II)	RECONFIGURE APRON
③	TAXILANE OFA (HANGARS)	LESS THAN STD. ADG I CLEARANCES	MODIFY WHERE FEASIBLE

LEGEND

	EXISTING	FUTURE
BUILDINGS	[Symbol]	[Symbol]
AIRFIELD PAVEMENT	[Symbol]	[Symbol]
BUILDING RESTRICTION LINE (BRL)	[Symbol]	[Symbol]
AIRPORT PROPERTY LINE	[Symbol]	[Symbol]
RUNWAY SAFETY AREA (RSA)	[Symbol]	[Symbol]
OBJECT FREE AREA (OFA)	[Symbol]	[Symbol]
OBSTACLE FREE ZONE (OFZ)	[Symbol]	[Symbol]
TAXIWAY OBJECT FREE AREA (TOFA)	[Symbol]	[Symbol]
RUNWAY PROTECTION ZONE (RPZ)	[Symbol]	[Symbol]
GROUND CONTOURS	[Symbol]	SAME
AIRPORT REFERENCE POINT (ARP)	[Symbol]	SAME
RUNWAY END IDENTIFIER LIGHTS (REIL)	[Symbol]	[Symbol]
WIND INDICATOR	[Symbol]	[Symbol]
SEGMENTED CIRCLE WIND INDICATOR	[Symbol]	[Symbol]
FENCE	[Symbol]	[Symbol]
BEACON	[Symbol]	[Symbol]
THRESHOLD LIGHTS	[Symbol]	[Symbol]
VISUAL GUIDANCE INDICATORS (PAPI)	[Symbol]	[Symbol]
ACCESS ROAD/VEHICLE PARKING	N/A	[Symbol]
AVIGATION EASEMENT	[Symbol]	SAME
TO BE REMOVED	[Symbol]	N/A
PROPERTY ACQUISITION	N/A	[Symbol]
TREES	[Symbol]	SAME
AVIATION DEVELOPMENT RESERVE	N/A	[Symbol]
VEGETATION	N/A	[Symbol]
SIDEWALK	N/A	[Symbol]
TTF ACCESS POINTS	[Symbol]	SAME

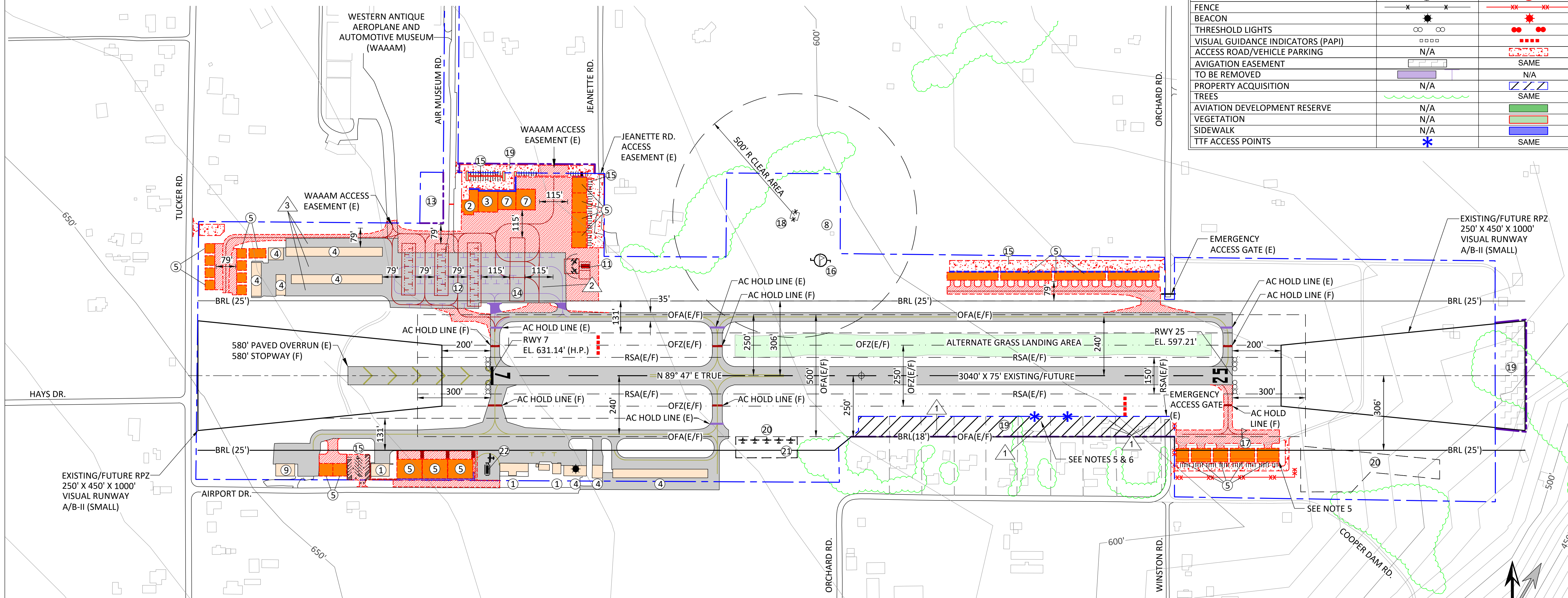

"THE PREPARATION OF THIS DOCUMENT MAY HAVE BEEN SUPPORTED, IN PART, THROUGH THE AIRPORT IMPROVEMENT PROGRAM FINANCIAL ASSISTANCE FROM THE FEDERAL AVIATION ADMINISTRATION (PROJECT NUMBER 3-41-0001-012-01) AS PROVIDED UNDER TITLE 49, UNITED STATES CODE, SECTION 47104. THE CONTENTS DO NOT NECESSARILY REFLECT THE OFFICIAL VIEWS OR POLICY OF THE FAA. ACCEPTANCE OF THIS REPORT BY THE FAA DOES NOT IN ANY WAY CONSTITUTE A COMMITMENT ON THE PART OF THE UNITED STATES TO PARTICIPATE IN ANY DEVELOPMENT DEPICTED THEREIN NOR DOES IT INDICATE THAT THE PROPOSED DEVELOPMENT IS ENVIRONMENTALLY ACCEPTABLE IN ACCORDANCE WITH APPROPRIATE PUBLIC LAWS."

- NOTES:**
- STOPWAY (F) AT WEST END OF RUNWAY WILL INCREASE FUTURE ACCELERATE - STOP DISTANCE AVAILABLE (ASDA) FOR RUNWAY 25 TO 3,620 FEET.
 - HIGH POINT (SURVEYED) ON RUNWAY IS 631.14' MSL. PUBLISHED AIRPORT ELEVATION (FAA A/FD) TO BE UPDATED FOR CONSISTENCY.
 - AIRPORT IS NOT SUBJECT TO 100-YEAR FLOODING.
 - FUTURE STOPWAY AT RUNWAY 7 END REQUIRES DECLARED DISTANCES AND STOPWAY DESIGNATION PUBLISHED IN FAA CHART SUPPLEMENT.
 - AIRPORT USES DEPICTED ON PARCELS ZONED EFU OR RR ARE SUBJECT TO FUTURE COMPREHENSIVE PLAN MAP AMENDMENT AND REZONE APPLICATION(S) AND DETERMINATION(S) BY HOOD RIVER COUNTY.
 - PROPERTY TO BE ACQUIRED TO ALLOW AIRPORT CONTROL OF RUNWAY OBJECT FREE AREA. CONFIGURATION OF PROPERTY TO BE ACQUIRED AND ACCOMMODATION OF EXISTING THROUGH THE FENCE AGREEMENTS WILL BE COORDINATED WITH THE PROPERTY OWNER.

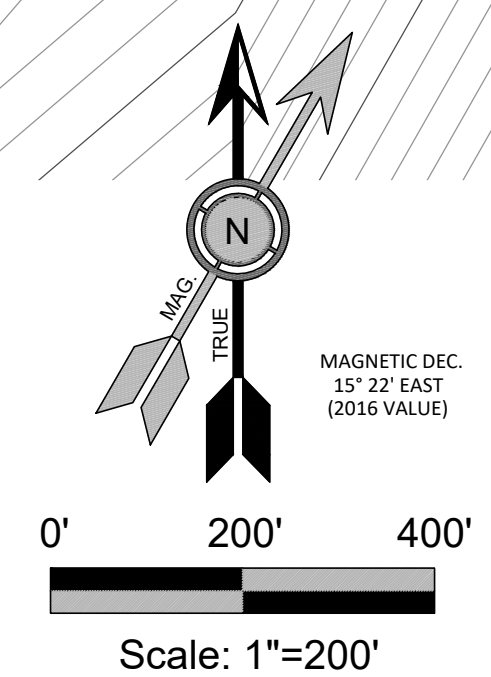

NO.	DATE	BY	APPR	REVISIONS

VERIFY SCALES
 BAR IS ONE INCH ON ORIGINAL DRAWING. 0" = 1" IF NOT ONE INCH ON THIS SHEET, ADJUST SCALES ACCORDINGLY.

FEDERAL AVIATION ADMINISTRATION APPROVAL
 APPROVAL DATE: _____
 SIGNATURE _____

PORT OF HOOD RIVER APPROVAL
 APPROVAL DATE: _____
 SIGNATURE _____

CENTURY WEST ENGINEERING

BEND OFFICE
 1020 SW EMKAY DRIVE, #100
 BEND, OR 97702
 541.322.8962 OFFICE
 541.382.2423 FAX

DESIGNED BY: DM DRAWN BY: JLS CHECKED BY: VMR SCALE: AS SHOWN
 DATE: MARCH 2018 PROJECT NO: 12399009.01

KEN JERNSTEDT AIRFIELD

AIRPORT LAYOUT PLAN

FIGURE NO. -
 SHEET NO. 3 OF 11